



ETA-Danmark A/S
Göteborg Plads 1
DK-2150 Nordhavn
Tel. +45 72 24 59 00
Fax +45 72 24 59 04
Internet www.etadanmark.dk

Authorised and notified according
to Article 29 of the Regulation (EU)
No 305/2011 of the European
Parliament and of the Council of 9
March 2011

MEMBER OF EOTA



European Technical Assessment ETA-16/0044 of 24/02/2016

I General Part

Technical Assessment Body issuing the ETA and designated according to Article 29 of the Regulation (EU) No 305/2011: ETA-Danmark A/S

Trade name of the construction product:

GH-Baubeschläge joist bearing Typ Alu Kombi-Mini, Typ Alu Kombi-Midi and Typ Alu Kombi-Maxi

Product family to which the above construction product belongs:

Three-dimensional nailing plate (Joist bearings)

Manufacturer:

GH-Baubeschläge GmbH
Austraße 34
D-73235 Weilheim/Teck
Tel. +49 7023 743323 0
Fax +49 7023 743323 29
Internet www.holzverbinder.de

Manufacturing plant:

Manufacturing Plant 1A

This European Technical Assessment contains:

34 pages including 3 annexes which form an integral part of the document

This European Technical Assessment is issued in accordance with Regulation (EU) No 305/2011, on the basis of:

Guideline for European Technical Approval (ETAG) No. 015 Three Dimensional Nailing Plates, April 2013, used as European Assessment Document (EAD).

This version replaces:

Translations of this European Technical Assessment in other languages shall fully correspond to the original issued document and should be identified as such.

Communication of this European Technical Assessment, including transmission by electronic means, shall be in full (excepted the confidential Annex(es) referred to above). However, partial reproduction may be made, with the written consent of the issuing Technical Assessment Body. Any partial reproduction has to be identified as such.

II SPECIFIC PART OF THE EUROPEAN TECHNICAL ASSESSMENT

1 Technical description of product and intended use

Technical description of the product

GH-Baubeschläge joist bearings are one-piece, face-fixed joist bearings to be used in timber to timber or timber to concrete or steel connections.

The joist bearings are made from aluminium alloy EN AW-6005A or EN AW-6060 according to EN 573-3:2009. Dimensions, hole positions, aluminium alloy and typical installations are shown in Annexes A and C.

2 Specification of the intended use in accordance with the applicable EAD

The joist bearings are intended for use in making end-grain to side-grain connections in load bearing timber structures, as a connection between a wood based joist and a solid timber or wood based header as well as connections between a timber joist and a concrete structure or a steel member, where requirements for mechanical resistance and stability and safety in use in the sense of the Basic Works Requirements 1 and 4 of Regulation (EU) 305/2011 shall be fulfilled.

The joist bearings can be installed as connections between wood based members such as:

- Structural solid timber classified to C14-C40 according to EN 338 / EN 14081,
- Glulam classified to GL24-GL36 according to EN 1194 / EN 14080,
- LVL according to EN 14374,
- Parallam PSL,
- Intrallam LSL,
- Duo- and Triobalken,
- Layered wood plates,

However, the calculation methods are only allowed for a characteristic wood density of up to 460 kg/m^3 . Even though the wood based material may have a larger density, this must not be used in the formulas for the load-carrying capacities of the fasteners.

Annex B states the formulas for the characteristic load-carrying capacities of the connections with joist bearings. The design of the connections shall be in accordance with Eurocode 5 or a similar national Timber Code.

It is assumed that the forces acting on the joist bearing connection are F_{up} or F_{down} perpendicular to the header

axis. The forces F_{up} and F_{down} shall act in the symmetry plane of the joist bearing. It is assumed that the forces are acting with an eccentricity e with regard to the side grain surface of the header.

It is assumed that the header beam is prevented from rotating. If the header beam only has installed a joist bearing on one side the eccentricity moment $M_v = F_d \cdot (B_H / 2 + e)$ shall be considered. The same applies when the header has joist bearing connections on both sides, but with vertical forces which differ more than 20%.

The joist bearings are intended for use for connections subject to static or quasi static loading.

The aluminium hangers are for use in timber structures subject to the dry, internal conditions defined by the service classes 1 and 2 of EN 1995-1-1:2004, (Eurocode 5).

The scope of the brackets regarding resistance to corrosion shall be defined according to national provisions that apply at the installation site considering environmental conditions and in conjunction with the admissible service conditions according to EN 1995-1-1 and the admissible corrosivity category as described and defined in EN ISO 12944-2

The provisions made in this European Technical Assessment are based on an assumed intended working life of the joist bearings of 50 years.

The indications given on the working life cannot be interpreted as a guarantee given by the producer or Assessment Body, but are to be regarded only as a means for choosing the right products in relation to the expected economically reasonable working life of the works.

3 Performance of the product and references to the methods used for its assessment

Characteristic	Assessment of characteristic
3.1 Mechanical resistance and stability*) (BWR1)	
Characteristic load-carrying capacity	See Annex B
Stiffness	No performance determined
Ductility in cyclic testing	No performance determined
3.2 Safety in case of fire (BWR2)	
Reaction to fire	The joist bearings are made from aluminium classified as Euroclass A1 in accordance with EN 1350-1 and EC decision 96/603/EC, amended by EC Decision 2000/605/EC
3.3 Hygiene, health and the environment (BWR3)	
Influence on air quality	The product does not contain/release dangerous substances specified in TR 034, dated March 2012
3.7 Sustainable use of natural resources (BWR7)	No performance determined
3.8 General aspects related to the performance of the product	The joist bearings have been assessed as having satisfactory durability and serviceability when used in timber structures using the timber species described in Eurocode 5 and subject to the conditions defined by service class 1 and 2
Identification	See Annex A

*) See additional information in section 3.9 – 3.12.

In addition to the specific clauses relating to dangerous substances contained in this European technical Assessment, there may be other requirements applicable to the products falling within its scope (e.g. transposed European legislation and national laws, regulations and administrative provisions). In order to meet the provisions of the Construction Products Regulation, these requirements need also to be complied with, when and where they apply.

3.9 Methods of verification

Safety principles and partial factors

The characteristic load-carrying capacities are based on the characteristic values of the screw connections and the steel plates. To obtain design values the capacities have to be divided by different partial factors for the material properties, the nail connection in addition multiplied with the coefficient k_{mod} .

According to EN 1990 (Eurocode – Basis of design) paragraph 6.3.5 the design value of load-carrying capacity may be determined by reducing the characteristic values of the load-carrying capacity with different partial factors.

Thus, the characteristic values of the load-carrying capacity are determined also for timber failure $F_{\text{Rk,H}}$ (obtaining the embedment strength of nails subjected to shear or the withdrawal capacity of the most loaded nail, respectively) as well as for steel plate failure $F_{\text{Rk,S}}$. The design value of the load-carrying capacity is the smaller value of both load-carrying capacities.

$$F_{\text{Rd}} = \min \left\{ \frac{k_{\text{mod}} \cdot F_{\text{Rk,H}}}{\gamma_{\text{M,H}}}, \frac{F_{\text{Rk,S}}}{\gamma_{\text{M,S}}} \right\}$$

Therefore, for timber failure the load duration class and the service class are included. The different partial factors γ_{M} for steel or timber, respectively, are also correctly taken into account.

3.10 Mechanical resistance and stability

See annex B for characteristic load-carrying capacities of the joist bearings.

The characteristic capacities of the joist bearings are determined by calculation as described in the EOTA Guideline 015 clause 5.1.1. They should be used for designs in accordance with Eurocode 5 or a similar national Timber Code.

The design models allow the use of fasteners described in the table on page 9 in Annex A:

- *Threaded nails (ringed shank nails), screws, bolts and dowels in accordance with EN 14592 or self-drilling dowels according to Annex A*
- *Self-tapping screws in accordance with ETA-12/0501*
- *Metal anchors in accordance with an ETA based on ETAG 001*

In the formulas in Annex B the capacities for threaded nails and screws calculated from the formulas of

Eurocode 5 are used assuming a thick steel plate when calculating the lateral fastener load-carrying-capacity.

No performance has been determined in relation to ductility of a joint under cyclic testing. The contribution to the performance of structures in seismic zones, therefore, has not been assessed.

No performance has been determined in relation to the joint's stiffness properties - to be used for the analysis of the serviceability limit state.

3.11 Aspects related to the performance of the product

3.11.1 Corrosion protection in service class 1, 2 and 3. In accordance with ETAG 015 the aluminium joist bearings are produced from aluminium alloys EN AW-6005A or EN AW-6060 according to EN 573-3:2009.

3.12 General aspects related to the use of the product

GH-Baubeschläge joist bearings are manufactured in accordance with the provisions of this European Technical Assessment using the manufacturing processes as identified in the inspection of the plant by the notified inspection body and laid down in the technical documentation.

Joist bearing connections

A joist bearing connection is deemed fit for its intended use provided:

Header – support conditions

- The header beam shall be restrained against rotation and be free from wane under the joist bearing.

If the header carries joists only on one side the eccentricity moment from the joists $M_{\text{ec}} = R_{\text{joist}} (b_{\text{header}}/2 + 86\text{mm})$ shall be considered for joist bearings Typ Kombi-Mini and Typ Kombi-Midi and $M_{\text{ec}} = R_{\text{joist}} (b_{\text{header}}/2 + 139\text{mm})$ for joist bearings Typ Kombi-Maxi at the strength verification of the header.

R_{joist} Reaction force from the joists
 b_{header} Width of header

- For a header with joists from both sides but with different reaction forces a similar consideration applies.

Wood to wood connections

- Joist bearings are fastened to wood-based headers by nails, bolts or screws and to wood-based joists by dowels.
 - There shall be nails or screws and dowels in all holes.
 - The characteristic capacity of the joist bearing connection is calculated according to the manufacturer's technical documentation, dated 2009-07-23.
 - The joist bearing connection is designed in accordance with Eurocode 5 or an appropriate national code.
 - The gap between the end of the joist and the surface, where contact stresses can occur during loading shall be limited. This means that for joist bearings the gap between the surface of the flaps and the end of the joist shall be maximum 8 mm.
 - The groove in the joist and the surface of the header shall have a plane surface against the whole joist bearing.
 - The depth of the joist shall be so large that the top (bottom) of the joist is at least $a_{4,t}$ above (below) the upper (lower) dowel in the joist.
 - Nails or screws to be used shall have a diameter and head shape, which fits the holes of the joist bearings.
- The upper bolts shall have washers according to EN ISO 7094.

Wood to concrete or steel

The above mentioned rules for wood to wood connections are applicable also for the connection between the joist and the joist bearing.

- The joist bearing connection is designed in accordance with Eurocodes 2, 3, 5 or 9 or an appropriate national code.
- The joist bearing shall be in close contact with the concrete or steel over the whole face. There shall be no intermediate layers in between.
- The gap between the end of the joist and the surface, where contact stresses can occur during loading shall be limited. This means that the gap between the end grain surface of the joist and that of the concrete or steel shall be maximum 27 mm.
- The bolt or metal anchor shall have a diameter not less than the hole diameter minus 2 mm.
- The bolts or metal anchors shall be placed symmetrically about the vertical symmetry line. There shall always be bolts in the 2 upper holes.

4 Attestation and verification of constancy of performance (AVCP)

4.1 AVCP system

According to the decision 97/638/EC of the European Commission¹, as amended, the system(s) of assessment and verification of constancy of performance (see Annex V to Regulation (EU) No 305/2011) is 2+.

5 Technical details necessary for the implementation of the AVCP system, as foreseen in the applicable EAD

Technical details necessary for the implementation of the AVCP system are laid down in the control plan deposited at ETA-Danmark

Issued in Copenhagen on 2016-02-24 by



Thomas Bruun
Managing Director, ETA-Danmark

Annex A

Product details and definitions

Joist bearing Typ Kombi-Mini

Face mount hanger with flanges without pre-punched holes for the joist connection. 6.0 mm thick aluminium alloy EN AW 6060 according to EN 573-3:2009.

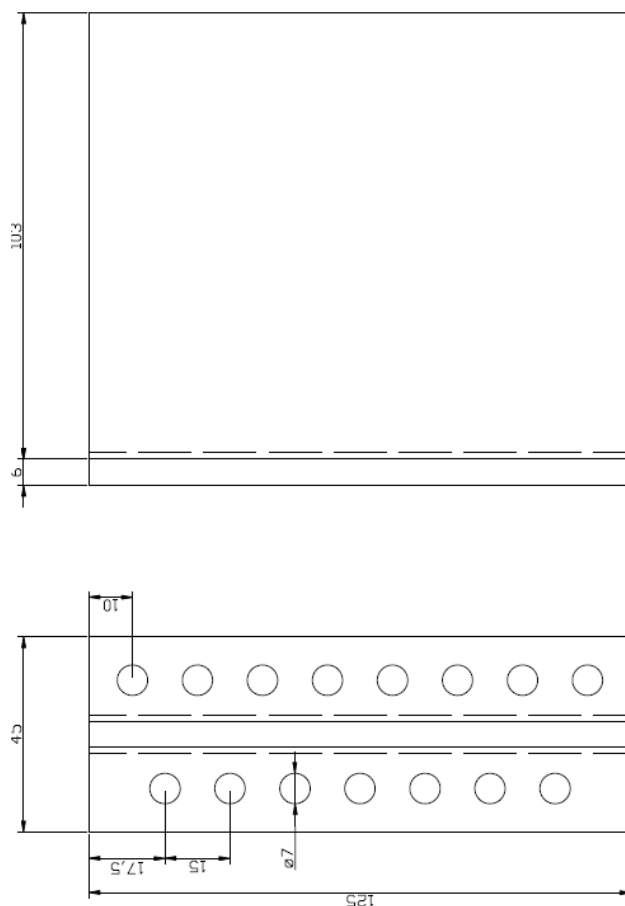

Drawing: joist bearing 125

Joist bearing	N° of nail holes	
	N°	d
65	7	7
95	11	7
125	15	7
155	19	7
185	23	7

For joist bearings Typ Kombi-Mini, the distance of the centroid of the joist connection from the header surface must not exceed 86 mm.

The joist bearing Typ Kombi-Mini are also supplied in lengths of 2165 mm, which are cut to fit the lengths in the above table.

Joist bearing Typ Kombi-Midi

Face mount hanger with flanges with or without pre-punched holes for the joist connection. 6.0 mm thick aluminium alloy EN AW 6005A according to EN 573-3:2009.

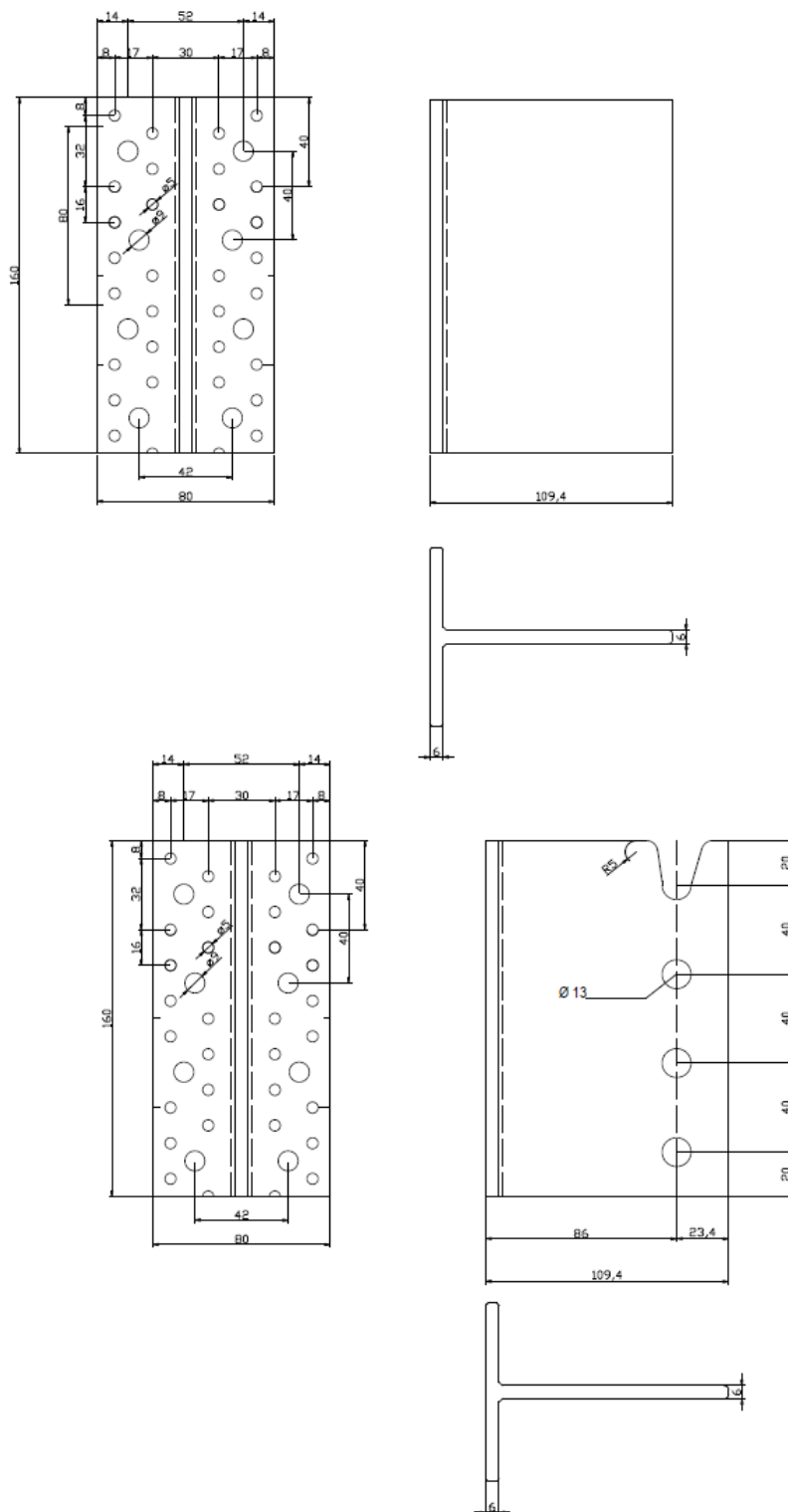

Drawing: Joist bearing Typ Kombi-Midi 160 with pre-punched holes for the joist connection (below), joist bearing Typ Kombi-Midi 160 without pre-punched holes for the joist connection (top)

Joist bearing	N° of nail holes		N° of dowel holes		N° of anchor holes	
	N°	d	N°	d	N°	d
80	14	5	-	-	4	9
120	22	5	3	13	6	9
160	30	5	4	13	8	9
200	38	5	5	13	10	9
240	46	5	6	13	12	9
280	54	5	7	13	14	9
320	62	5	8	13	16	9
360	70	5	9	13	18	9
400	78	5	10	13	20	9

For joist bearings Typ Kombi-Midi without pre-punched holes, the distance of the centroid of the joist connection from the header surface must not exceed 86 mm.

The joist bearings Typ Kombi-Midi are also supplied in lengths of 2200 mm, which are cut to fit the lengths in the above table.

Joist bearing Typ Kombi-Maxi

Face mount hanger with flanges with pre-punched holes for the joist connection. 10.0 and 12.0 mm thick aluminium alloy EN AW 6005A according to EN 573-3:2009.

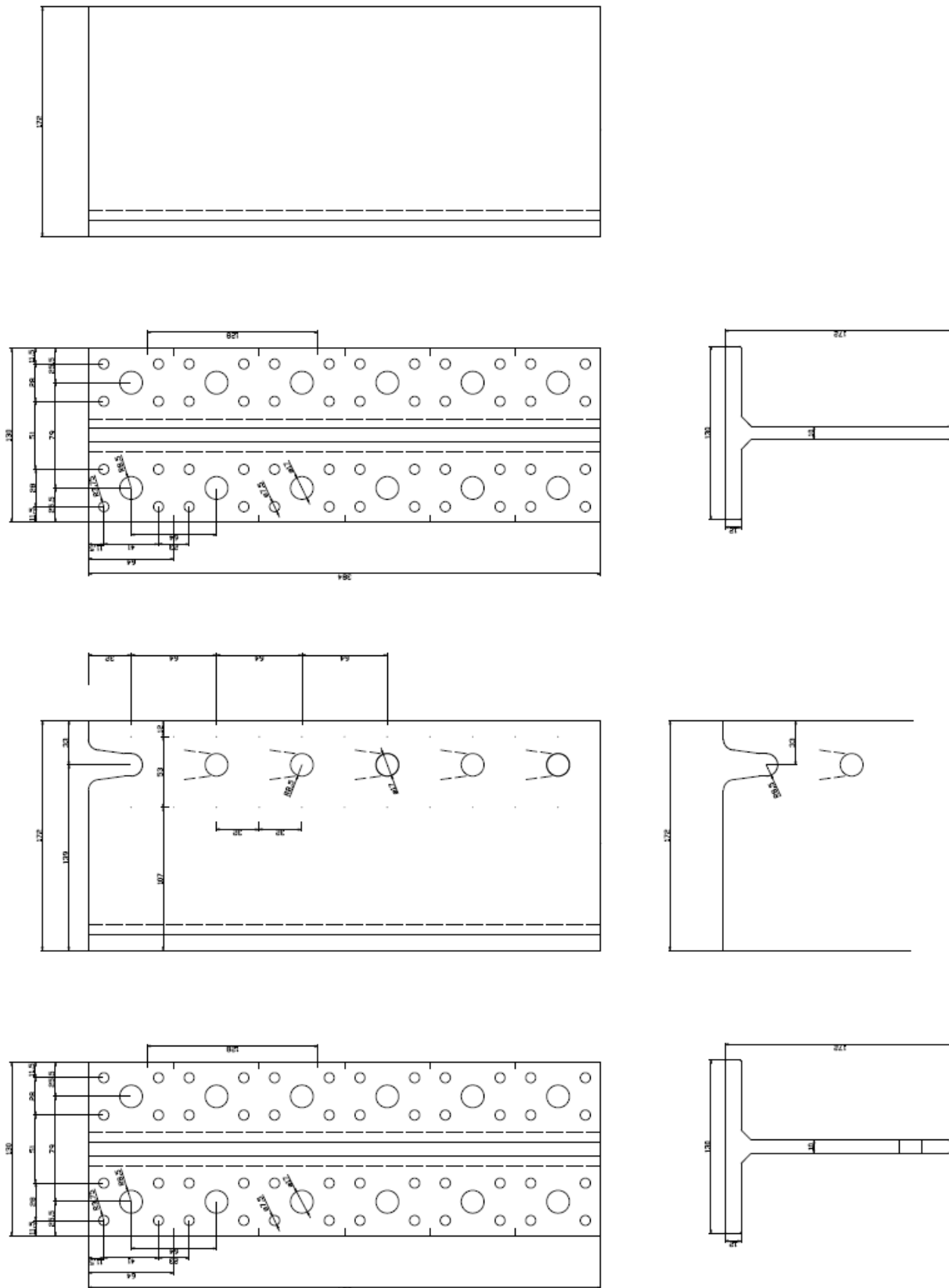

Drawing: Joist bearing Typ Kombi-Maxi 384 with pre-punched holes for the joist connection (below), joist bearing Typ Kombi-Maxi 384 without pre-punched holes for the joist connection (top)

Joist bearing	N° of nail holes		N° of dowel holes		N° of anchor/bolt holes	
	N°	d	N°	d	N°	d
320	40	7,5	5	17	10	17
384	48	7,5	6	17	12	17
448	56	7,5	7	17	14	17
512	64	7,5	8	17	16	17
576	72	7,5	9	17	18	17
640	80	7,5	10	17	20	17
704	88	7,5	11	17	22	17
768	96	7,5	12	17	24	17
832	104	7,5	13	17	26	17
896	112	7,5	14	17	28	17
960	120	7,5	15	17	30	17

For joist bearings Typ Kombi-Maxi without pre-punched holes, the distance of the centroid of the joist connection from the header surface must not exceed 139 mm.

The joist bearings Typ Kombi-Maxi are also supplied in lengths of 2176 mm, which are cut to fit the lengths in the above table.

Fastener types and sizes

NAIL diameter	Length	Nail type
4.0	40 - 100	Ringed shank nails according to EN 14592 or ETA
6.0	60 - 100	Ringed shank nails according to EN 14592 or ETA

In the formulas in Annex B the capacities for threaded nails calculated from the formulas of Eurocode 5 are used assuming a thick steel plate when calculating the lateral nail load-carrying-capacity. The load bearing capacities of the joist bearings have been determined based on the use of connector nails 6,0 x L mm (Typ Kombi-Mini and Typ Kombi-Maxi) and 4,0 x L mm (Typ Kombi-Midi) in accordance with the German national approval for the nails. The characteristic withdrawal capacity of the nails has to be determined by calculation in accordance with EN 1995-1-1: 2004, paragraph 8.3.2 (head pull-through is not relevant):

$$F_{ax,Rk} = f_{1,k} \times d \times t_{pen}$$

Where:

$f_{1,k}$ Characteristic value of the withdrawal parameter in N/mm²

d Nail diameter in mm

t_{pen} Penetration depth of the profiled shank in mm

Based on tests by Versuchsanstalt für Stahl, Holz und Steine, University of Karlsruhe, the characteristic value of the withdrawal resistance for the threaded nails used can be calculated as:

$$f_{1,k} = 50 \times 10^{-6} \times \rho_k^2$$

Where:

ρ_k Characteristic density of the timber in kg/m³

The shape of the nail directly under the head shall be in the form of a truncated cone with a diameter under the nail head which exceeds the hole diameter.

Screw diameter	Length	Screw type
5.0	40 - 120	Self-tapping screw according to EN 14592 or ETA

In the formulas in Annex B the capacities for self-tapping screws calculated from the formulas of Eurocode 5 are used assuming a thick steel plate when calculating the lateral load-carrying-capacity. The load bearing capacities of the joist bearings type Typ Kombi-Mini have been determined based on the use of screws 5,0 x L mm in accordance with the ETA-12/0501 for the screws and joist bearings type Typ Kombi-Midi have been determined based on the use of screws 5,0 x L mm in accordance with the ETA-12/0501 for the screws. The characteristic withdrawal capacity of the screws has to be determined by calculation:

$$F_{ax,Rk} = f_{1,k} \times d \times t_{pen}$$

Where:

$f_{1,k}$ Characteristic value of the withdrawal parameter in N/mm²

d Screw diameter in mm

t_{pen} Penetration depth of the thread in mm

Based on tests by Versuchsanstalt für Stahl, Holz und Steine, University of Karlsruhe, the characteristic value of the withdrawal resistance for the self-tapping screws used can be calculated as:

$$f_{1,k} = 80 \times 10^{-6} \times \rho_k^2$$

Where:

ρ_k Characteristic density of the timber in kg/m³

Based on ETA-12/0501, the characteristic value of the withdrawal resistance for GH-Baubeschläge LBS screws $d = 5.0$ mm is:

$$f_{ax,k} = 11,7 \text{ N/mm}^2$$

Based on the ETA-12/0501 the characteristic value of the withdrawal resistance for the screws type GHS and GHS+, $d = 8.0$ mm used may be calculated as:

$$f_{ax,k} = 11,7 \text{ N/mm}^2$$

The shape of the screw directly under the head shall be in the form of a truncated cone with a diameter under the screw head which exceeds the hole diameter (see annex A of ETA-12/0501).

BOLTS, METAL ANCHORS or DOWELS diameter	Corresponding hole diameter in aluminium plate	Fastener type
5.0 to 8.0	Max. 0.5 mm larger than the dowel diameter	Dowels according to manufacturer's specification
5.5 and 7.5	-	RB self-drilling dowels
6.0 - 8.0	Max. 0.5 mm larger than the dowel diameter	Dowels according to EN 14592
10.0	Max. 1 mm larger than the bolt or dowel diameter	Bolts or dowels according to EN 14592, metal anchors according to manufacturer's specification
12.0		
16.0		

Annex B

Characteristic values of load-carrying-capacities

The downward and the upward directed forces are assumed to act in the middle of the joist.

Only a full nailing pattern is specified, where there are nails in all the holes of the header connection. Also dowels are placed in all the dowel holes in the joist. For header connections with bolts or metal anchors, there must always be at least bolts or metal anchors in the two upper two holes for loading DOWN or in the two lower holes for loading up.

B.1 Joist bearings Typ Kombi-Maxi, Typ Kombi-Midi and Typ Kombi-Mini fastened with nails or screws and dowels

$$F_{Z,Rk} = \min \left\{ \frac{n_{J,ef} \cdot F_{v,J,Rk}}{\sqrt{\left(\frac{1}{n_H \cdot F_{v,H,Rk}}\right)^2 + \left(\frac{1}{k_H \cdot F_{ax,H,Rk}}\right)^2}} \right\} \quad (B.1)$$

$n_{J,ef}$ effective number of dowels in the joist, see Table B.1

n_H total number of nails or screws in the side of the header

$F_{v,J,Rk}$ Characteristic lateral load-carrying capacity of a dowel with two shear planes in the joist

$F_{v,H,Rk}$ Characteristic lateral load-carrying capacity of a nail or screw in single shear in the header assuming a thick plate

$F_{ax,H,Rk}$ Characteristic axial load-carrying capacity of a nail or screw in the header

k_H form factor, see Table B.1

The load-carrying capacity $F_{v,J,Rk}$ of the connection with RB self-drilling dowels may be calculated according to Eurocode 5 using the characteristic yield moment $M_{y,k} = 29 \text{ Nm}$ for $d=5.5 \text{ mm}$ and $M_{y,k} = 64 \text{ Nm}$ for $d=7.5 \text{ mm}$.

Table B.1.1: GH-Baubeschläge joist bearings: Form factors k_H and effective number of dowels $n_{J,ef}$

Joist bearing	n_J	n_H	k_H	$n_{J,ef}$	k_H	$n_{J,ef}$
			Loading DOWN		Loading UP	
Typ Kombi-Mini 65	depending on design	7	1,32	n_J	1,32	n_J
Typ Kombi-Mini 95		11	6,72	n_J	6,72	n_J
Typ Kombi-Mini 125		15	12,6	n_J	12,6	n_J
Typ Kombi-Mini 155		19	20,4	n_J	20,4	n_J
Typ Kombi-Mini 185		23	30,1	n_J	30,1	n_J
Typ Kombi-Midi 80		14	1,83	n_J	1,83	n_J
Typ Kombi-Midi 120*	3	22	9,12	2,89	8,57	1,92
Typ Kombi-Midi 160*	4	30	17,1	3,85	16,3	2,89
Typ Kombi-Midi 200*	5	38	27,5	4,81	26,6	3,85
Typ Kombi-Midi 240*	6	46	40,4	5,77	39,3	4,81
Typ Kombi-Midi 280*	7	54	55,8	6,74	54,5	5,77
Typ Kombi-Midi 320*	8	62	73,6	7,70	72,1	6,74
Typ Kombi-Midi 360*	9	70	94,0	8,66	92,3	7,70
Typ Kombi-Midi 400*	10	78	116,7	9,62	114,7	8,66
Typ Kombi-Maxi 320*	5	40	30,0	5	30,0	4
Typ Kombi-Maxi 384*	6	48	43,3	6	43,3	5

Typ Kombi-Maxi 448*	7	56	59,1	7	59,1	6
Typ Kombi-Maxi 512*	8	64	77,4	8	77,4	7
Typ Kombi-Maxi 576*	9	72	98,1	9	98,1	8
Typ Kombi-Maxi 640*	10	80	121	10	121	9
Typ Kombi-Maxi 704*	11	88	147	11	147	10
Typ Kombi-Maxi 768*	12	96	175	12	175	11
Typ Kombi-Maxi 832*	13	104	205	13	205	12
Typ Kombi-Maxi 896*	14	112	238	14	238	13
Typ Kombi-Maxi 960*	15	120	274	15	274	14

* For Typ Kombi-Midi and Typ Kombi-Maxi without prepunched holes, $n_J = n_{J,ef}$ depends on the design.

B.2 Joist bearings fastened with bolts or metal anchors and dowels

$$F_{Z,Rk} = \min \left\{ \begin{array}{l} n_{J,ef} \cdot F_{v,J,Rk} \\ \frac{1}{\sqrt{\left(\frac{1}{n_H \cdot F_{v,H,Rk}} \right)^2 + \left(\frac{e \cdot z_{max}}{I_{p,H,ax} \cdot F_{ax,H,Rk}} \right)^2}} \end{array} \right. \quad (B.2)$$

n_H Number of bolts or metal anchors in the header connection; there must always be at least bolts or metal anchors in the two upper to holes for loading DOWN or in the two lower holes for loading up;

e Distance between the centroid of the joist connection and the header surface;

z_{max} Distance between the uppermost bolt or metal anchor and the lower end of the joist bearing for loading DOWN or distance between the lowermost bolt or metal anchor and the upper end of the joist bearing for loading UP;

$I_{p,H,ax}$ Polar moment of inertia of the header fasteners where the centre of rotation may be assumed at the lower or upper end of the joist bearing;

$F_{v,H,Rk}$ Characteristic value of the lateral load-carrying-capacity per bolt or metal anchor in the header connection;

$F_{ax,H,Rk}$ Characteristic value of the axial load-carrying-capacity per bolt or metal anchor in the header;

Annex C
Installation of joist bearings

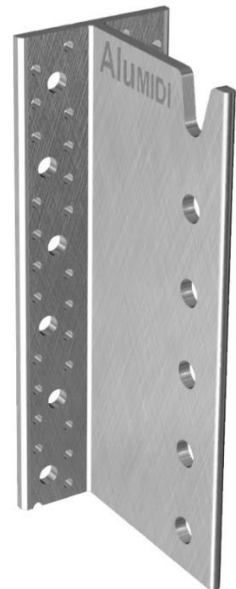
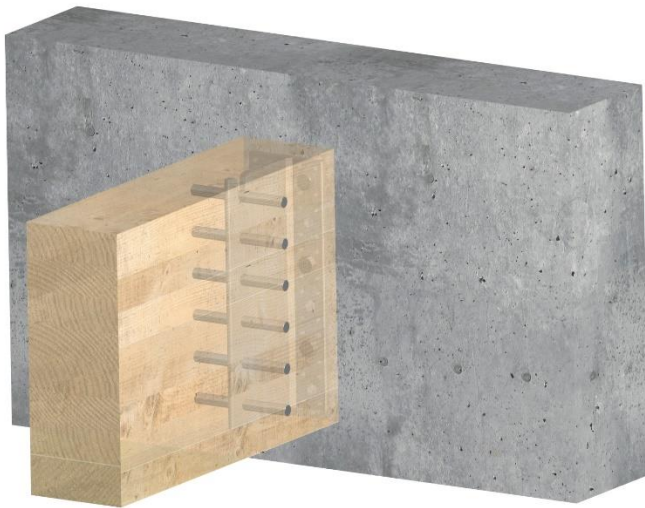
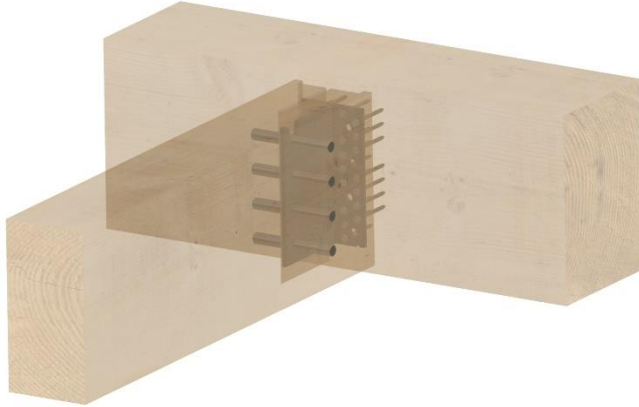

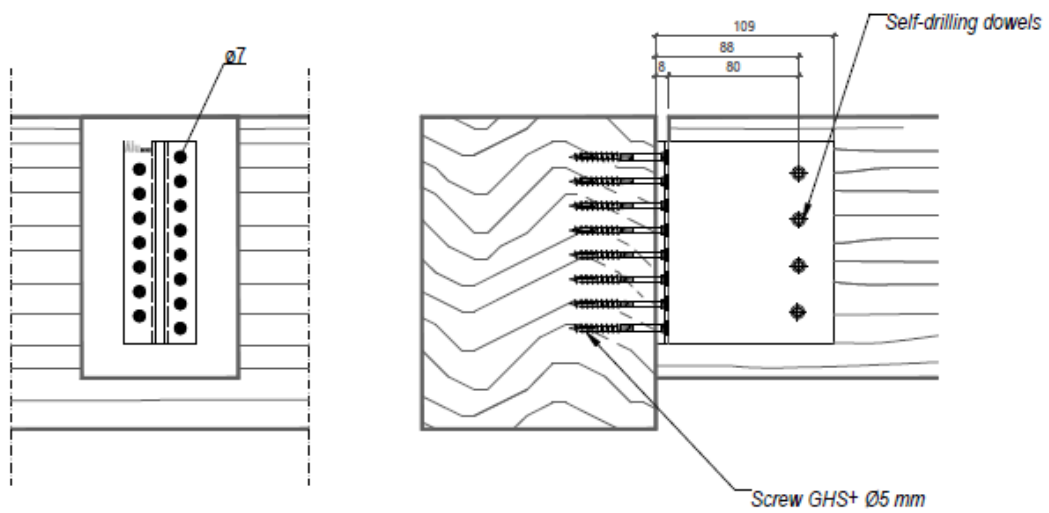

Austraße 34
 73235 Weilhelm/Teck
 Tel 07023/743323-0
 Fax 07023/743323-90
 www.holzverbinder.de
 Info@holzverbinder.de

User

Alu Mini Timber-Timber
 Screws GHS+ Ø5 mm - Self-drilling dowels Ø5

Annex

1a

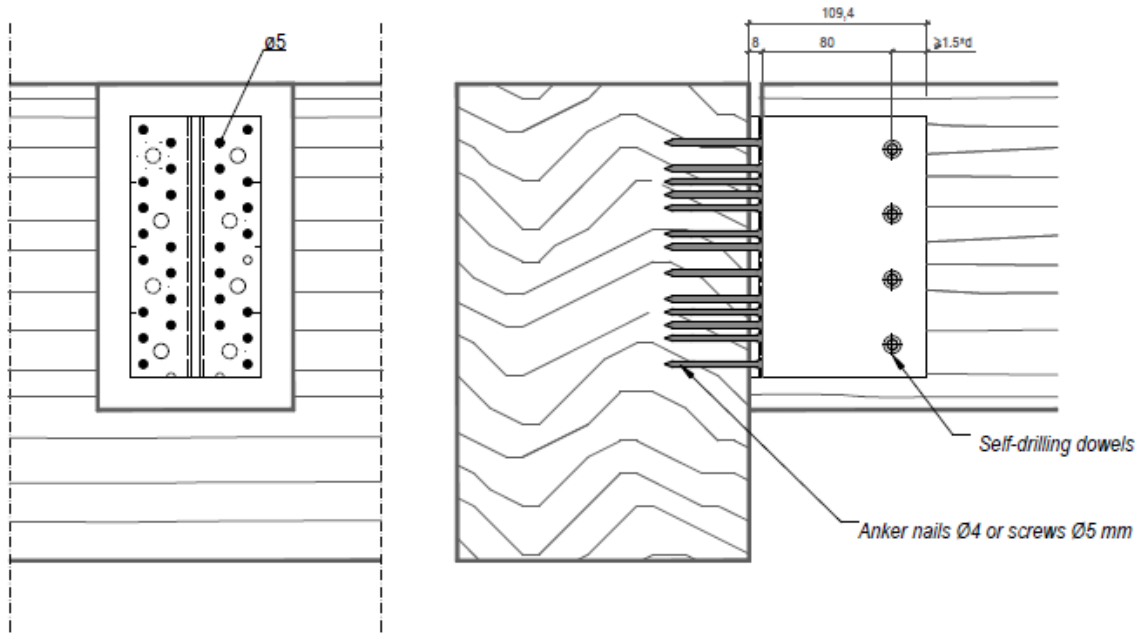

Austraße 34
 73235 Weilheim/Teck
 Tel 07023/743323-0
 Fax 07023/743323-90
 www.holzverbinder.de
 info@holzverbinder.de

Use:

Alu Kombi Midi Timber-Timber
 Anker nails Ø6 or screws Ø 5 - Self-drilling dowels Ø5

Annex:

2a

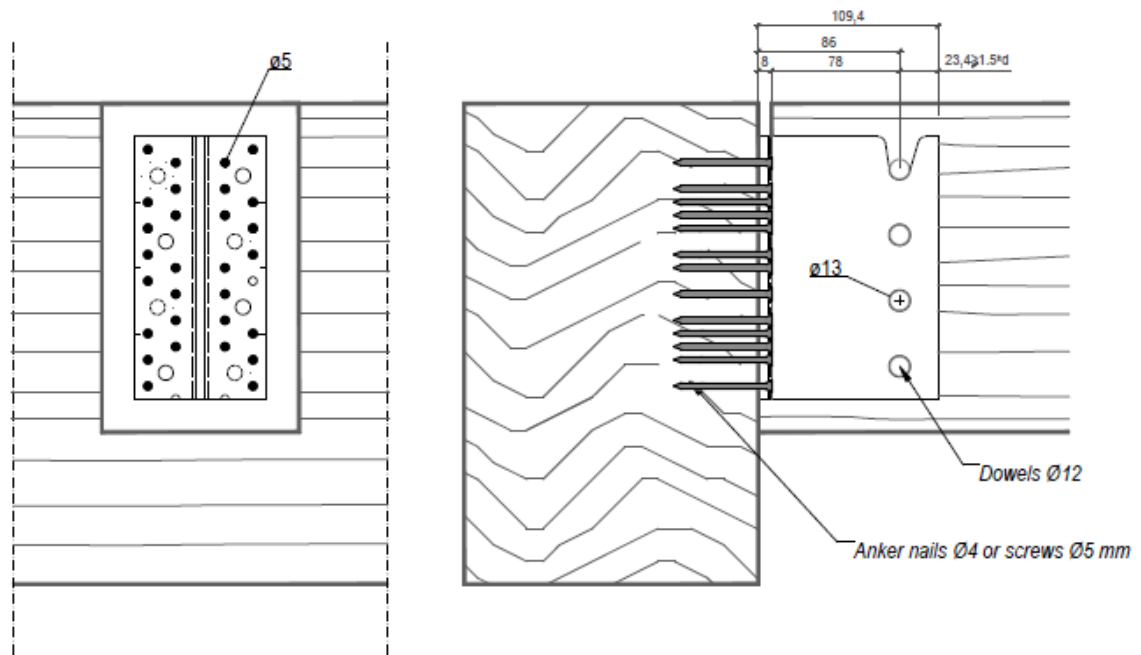

Austraße 34
 73235 Weilheim/Teck
 Tel 07023/743323-0
 Fax 07023/743323-90
 www.holzverblinder.de
 Info@holzverblinder.de

User:

Alu Kombi Midi Timber-Timber
 Anker nails Ø4 or screws Ø5 mm - Dowels Ø12 mm

Annex:

3a

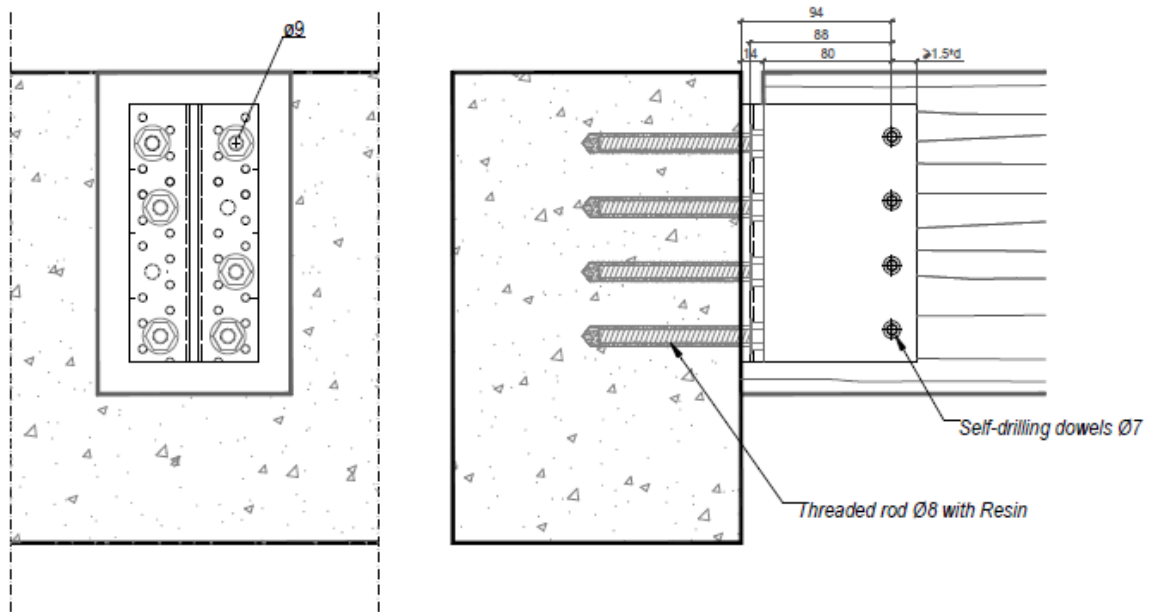

Austraße 34
73235 Weilheim/Teck
Tel 07023/743323-0
Fax 07023/743323-90
www.holzverbinder.de
Info@holzverbinder.de

Use:

Alu Kombi Midi Timber–Concrete
Threaded rod Ø8 with resin - Self-drilling dowels Ø7

Annex:

4a

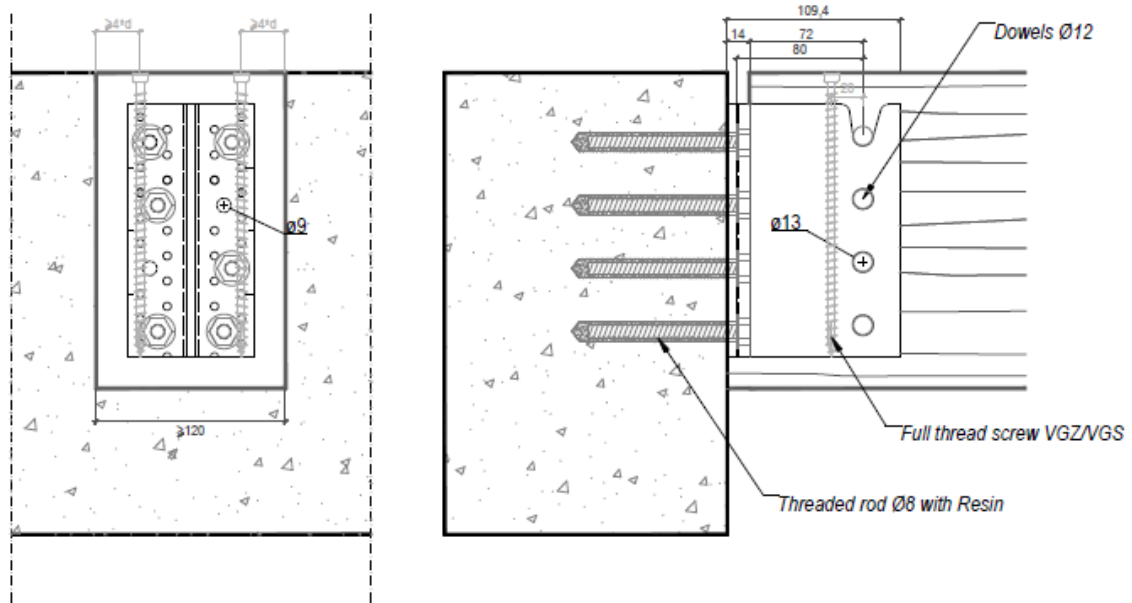

Austraße 34
73235 Weilheim/Teck
Tel 07023/743323-0
Fax 07023/743323-90
www.holzverbinder.de
Info@holzverbinder.de

Use:

Alu Kombi Midi Timber-Concrete
Threaded rod $\varnothing 8$ mm with resin - Dowels $\varnothing 12$ mm

Annex:

5a

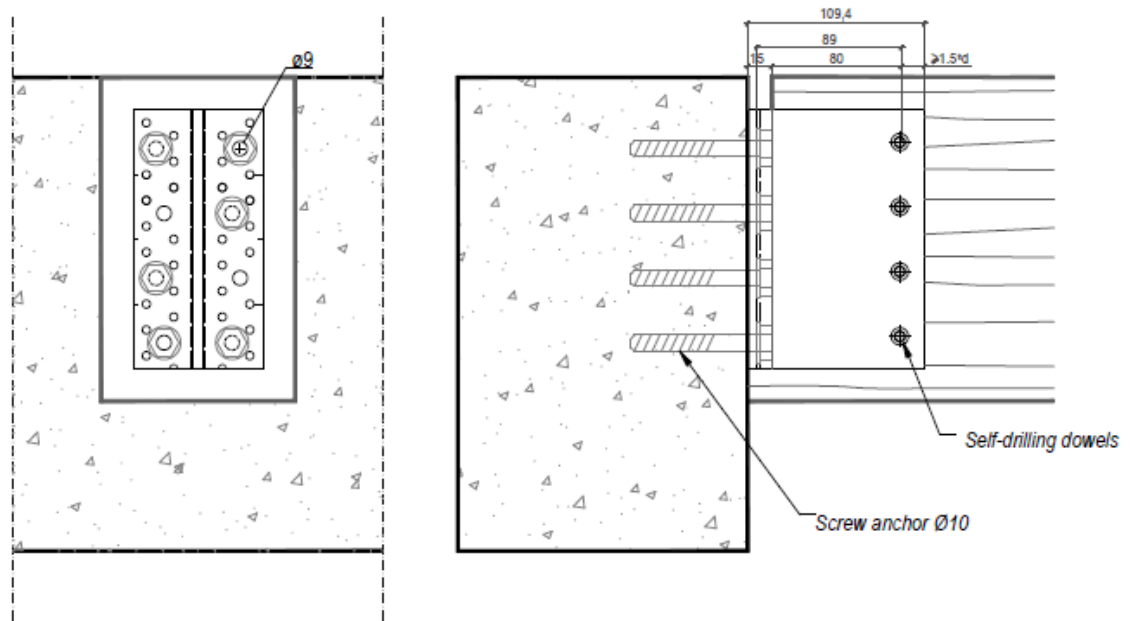

Austraße 34
 73235 Weilheim/Teck
 Tel 07023/743323-0
 Fax 07023/743323-90
 www.holzverbinder.de
 info@holzverbinder.de

User:

Alu Kombi Midi Timber–Concrete
 Screw anchor $\varnothing 10$ mm - Self-drilling dowels $\varnothing 7$

Annex:

6a

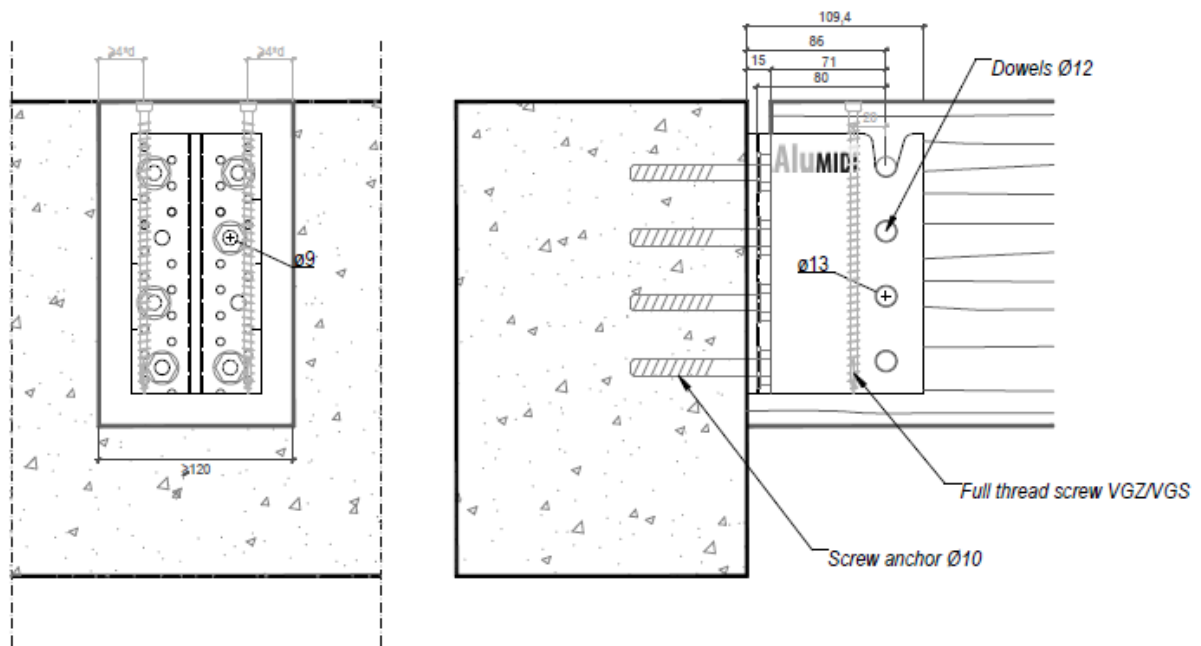

Austraße 34
 73235 Weilheim/Teck
 Tel 07023/743323-0
 Fax 07023/743323-90
 www.holzverbinder.de
 info@holzverbinder.de

Use:

Alu Kombi Midi Timber–Concrete
 Screw anchor Ø10 mm - Dowels Ø12 mm

Annex:

7a

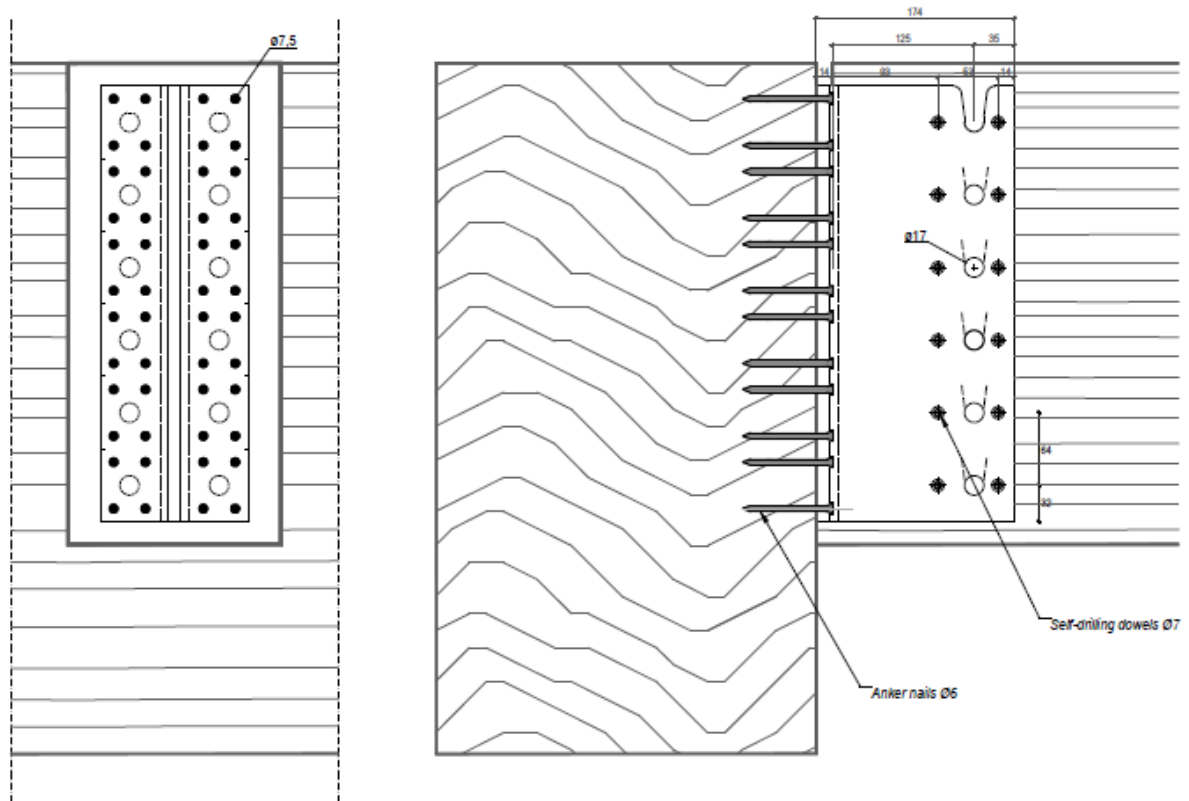

Austraße 34
 73235 Weilheim/Teck
 Tel 07023/743323-0
 Fax 07023/743323-90
 www.holzverbinder.de
 info@holzverbinder.de

User:

Alu Kombi Maxi Timber-Timber
 Anker nails Ø6 mm - Self drilling dowels Ø7 mm

Annex:

8a

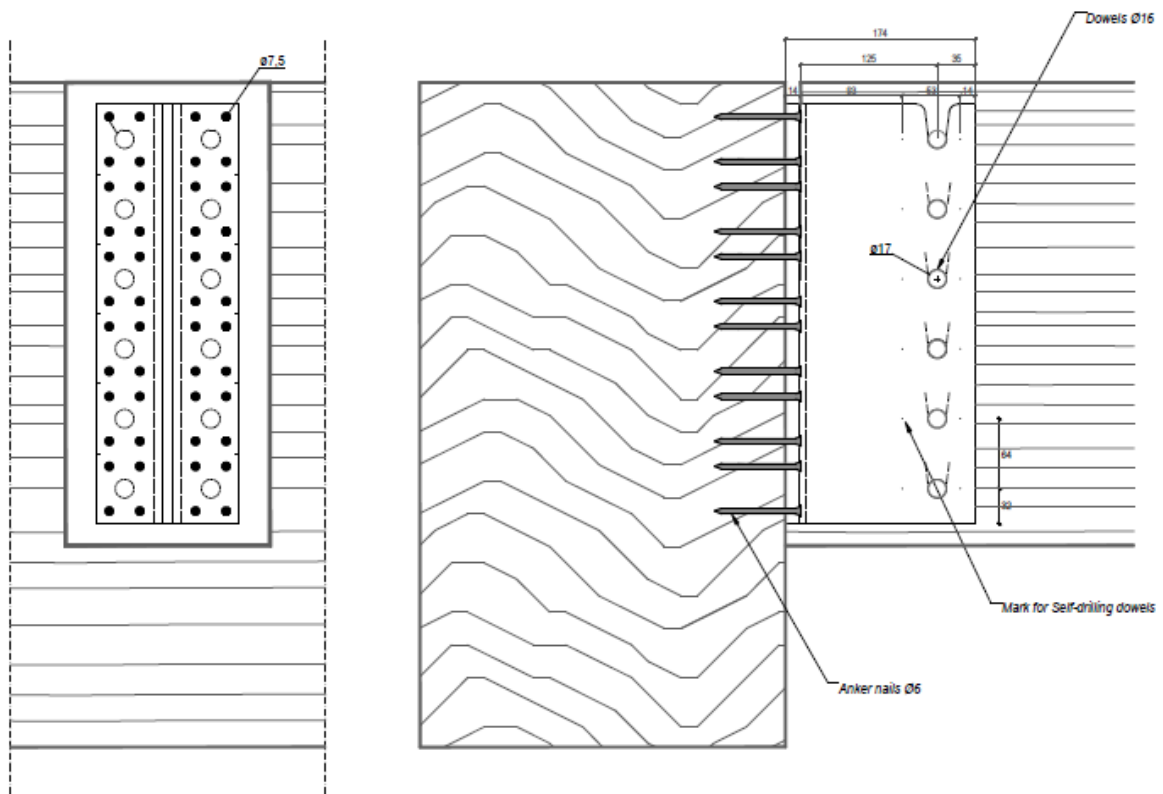

Austraße 34
 73235 Weilheim/Teck
 Tel 07023/743323-0
 Fax 07023/743323-90
www.holzverbinder.de
Info@holzverbinder.de

User:

Alu Kombi Maxi Timber-Timber
Anker nails Ø6 mm - Dowels Ø16 mm

Annex:

9a

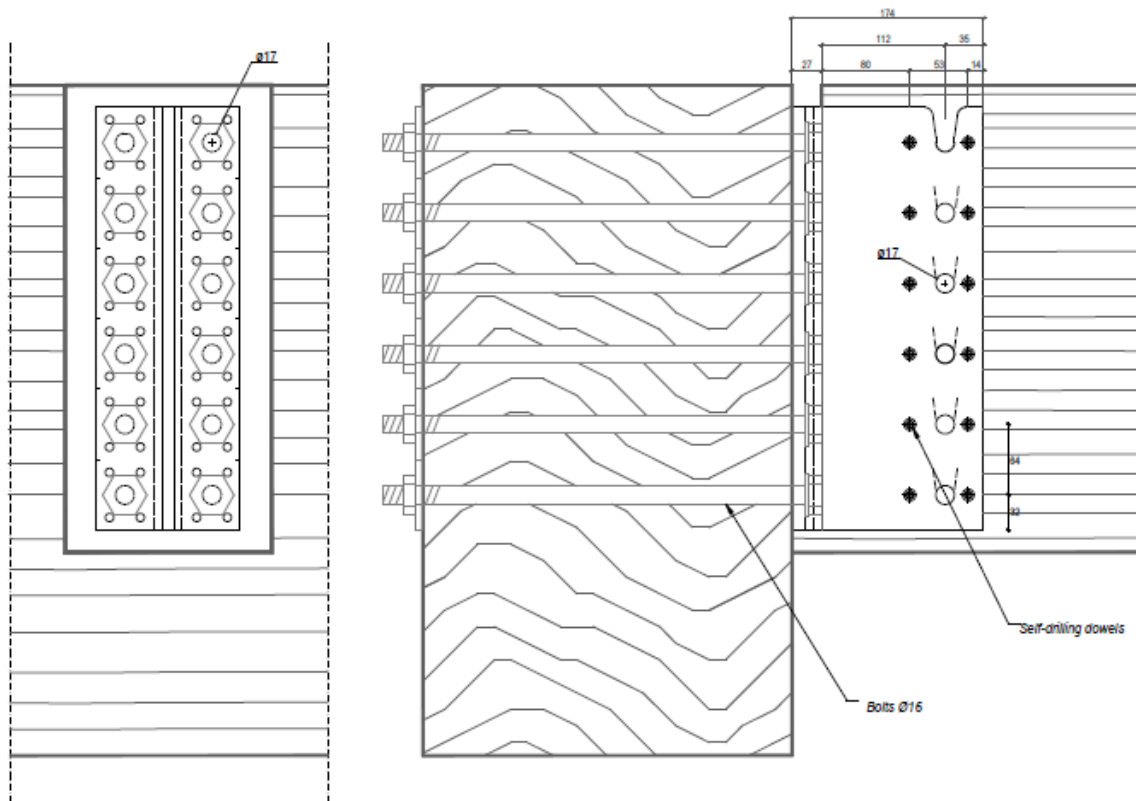

Austraße 34
 73235 Weilheim/Teck
 Tel 07023/743323-0
 Fax 07023/743323-90
 www.holzverbinder.de
 info@holzverbinder.de

Use:

Alu Kombi Maxi Timber-Timber
 Bolts Ø16 mm - Self drilling dowels Ø7 mm

Annex:

10a

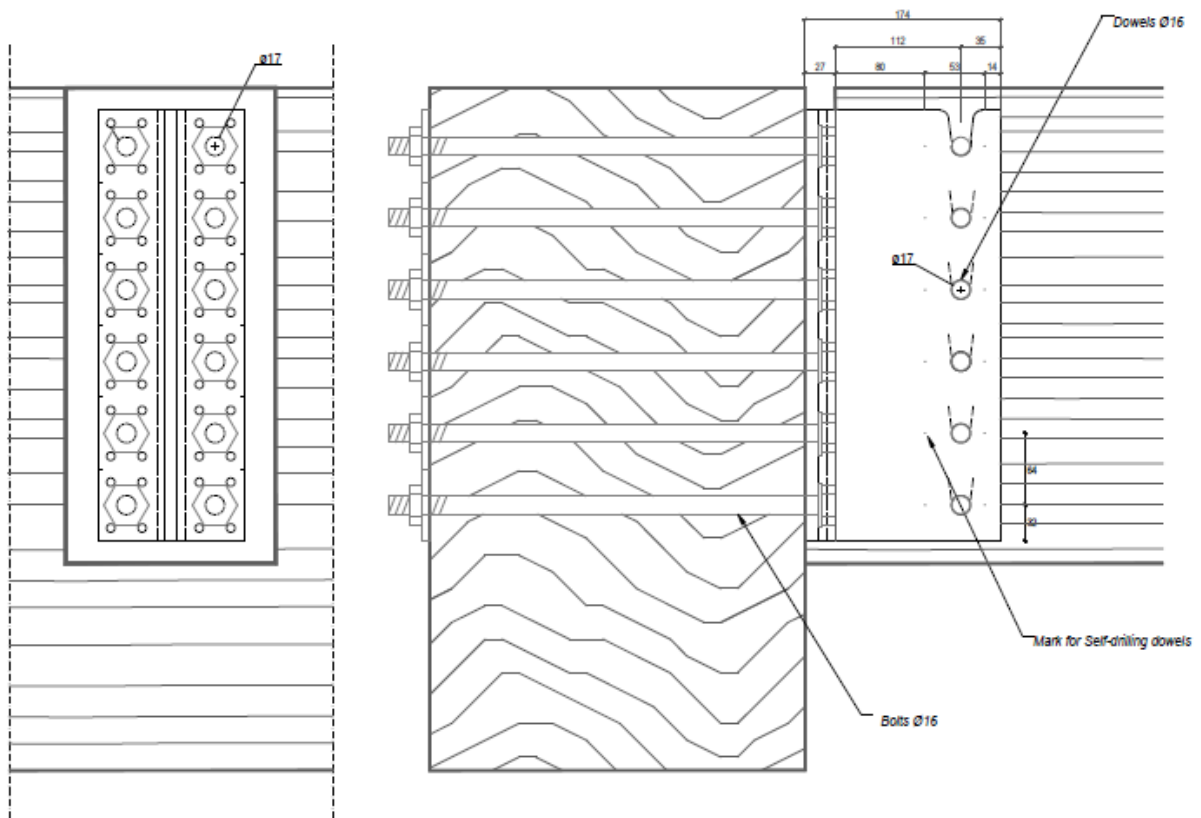

Austraße 34
73235 Weilheim/Teck
Tel 07023/743323-0
Fax 07023/743323-90
www.holzverbinder.de
Info@holzverbinder.de

User:

Alu Kombi Maxi Timber-Timber
Bolts Ø16 mm - Dowels Ø16 mm

Annex:

11a

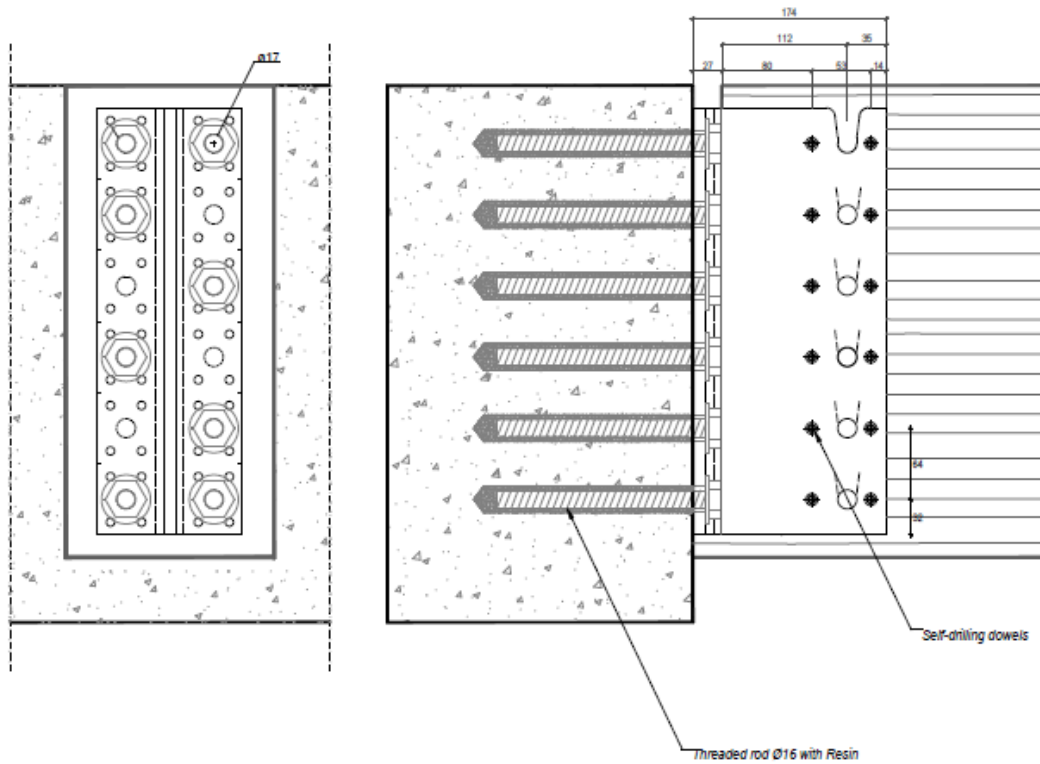

Austraße 34
 73235 Weilheim/Teck
 Tel 07023/743323-0
 Fax 07023/743323-90
 www.holzverblinder.de
 info@holzverblinder.de

Use:

Alu Kombi Maxi Timber-Concrete
 Threaded rod Ø16 mm with resin - Self drilling dowels Ø7 mm

Annex:

12a

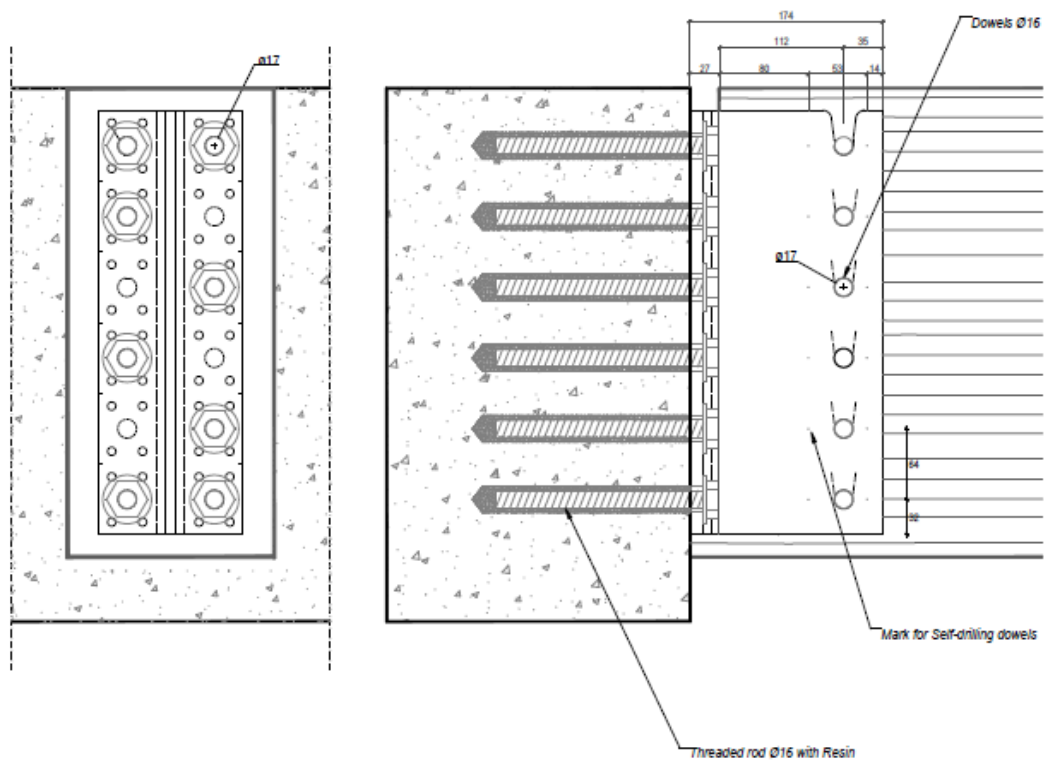

Austraße 34
 73235 Weilheim/Teck
 Tel 07023/743323-0
 Fax 07023/743323-90
 www.holzverbinder.de
 info@holzverbinder.de

Use:

Alu Kombi Maxi Timber-Concrete
 Threaded rod Ø16 mm with resin - Dowels Ø16 mm

Annex:

13a

Alu Mini

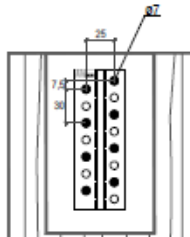

Alu Kombi Midi

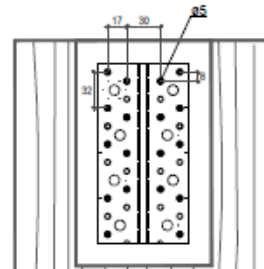

Alu Kombi Maxi

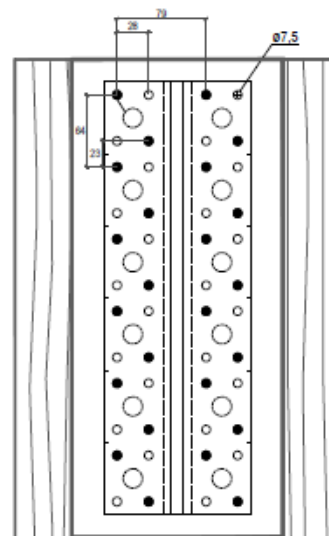
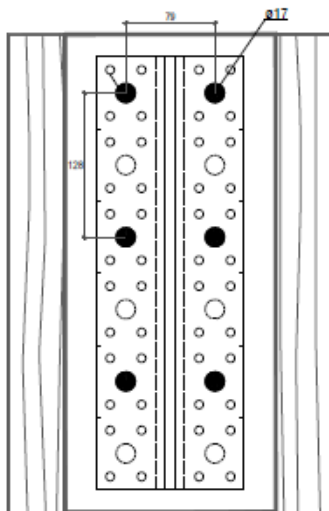

Austraße 34
73235 Weilheim/Teck
Tel 07023/743323-0
Fax 07023/743323-90
www.holzverblinder.de
Info@holzverblinder.de

Use:

Alu Mini – Alu Kombi Midi –
– Alu Kombi Maxi Timber–Timber
Load parallel to grain (Column)

Annex:

14a

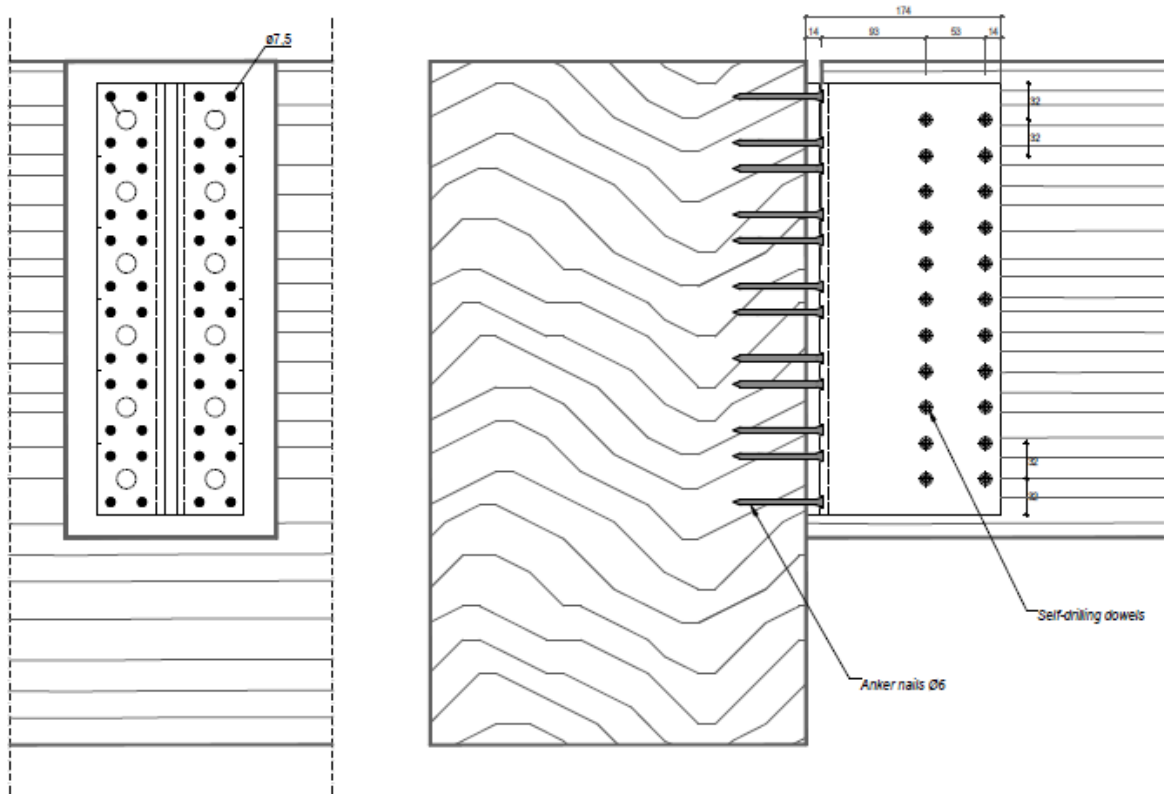

Austraße 34
 73235 Weilheim/Teck
 Tel 07023/743323-0
 Fax 07023/743323-90
 www.holzverblinder.de
 info@holzverblinder.de

Use:

Alu Kombi Maxi without holes
 Timber-Timber
 Anker nails Ø6 mm - Self drilling dowels Ø7 mm

Annex:

15a

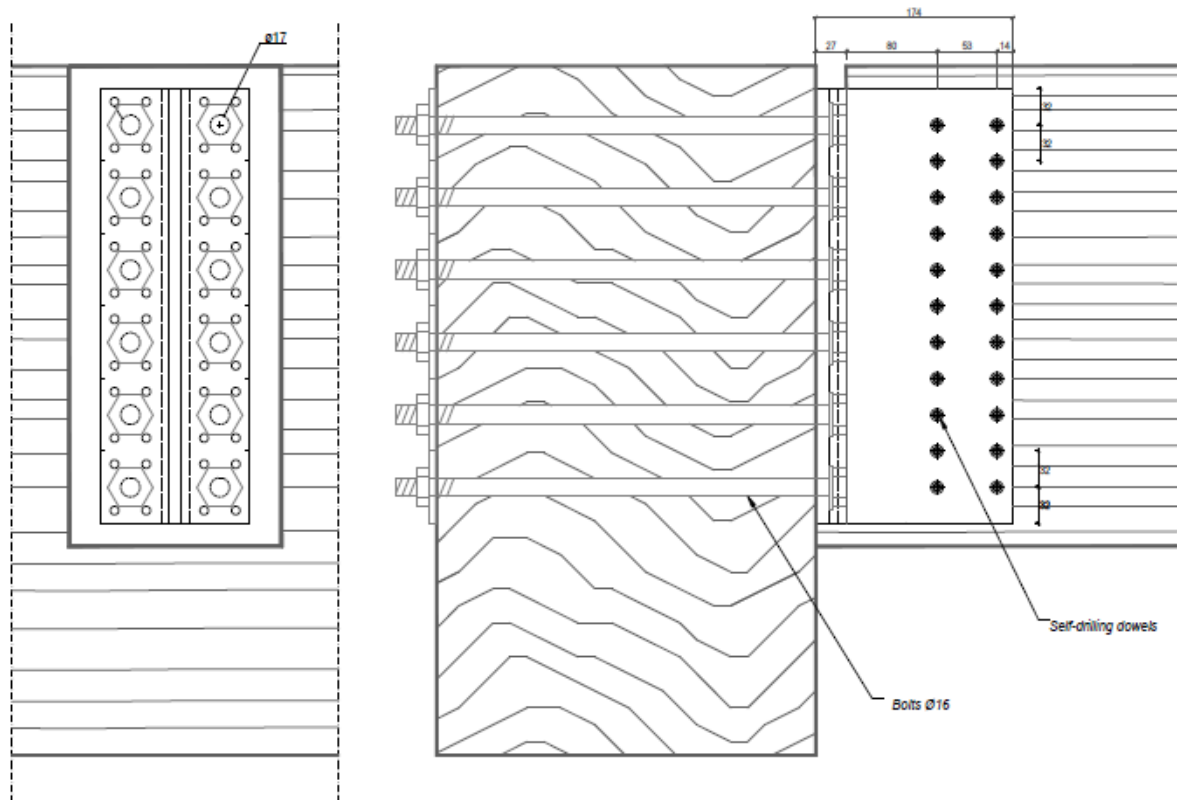

Austraße 34
73235 Weilheim/Teck
Tel 07023/743323-0
Fax 07023/743323-90
www.holzverbinder.de
info@holzverbinder.de

Use:

Alu Kombi Maxi without holes
Timber-Timber
Bolts Ø16 mm - Self drilling dowels Ø7 mm

Annex:

16a

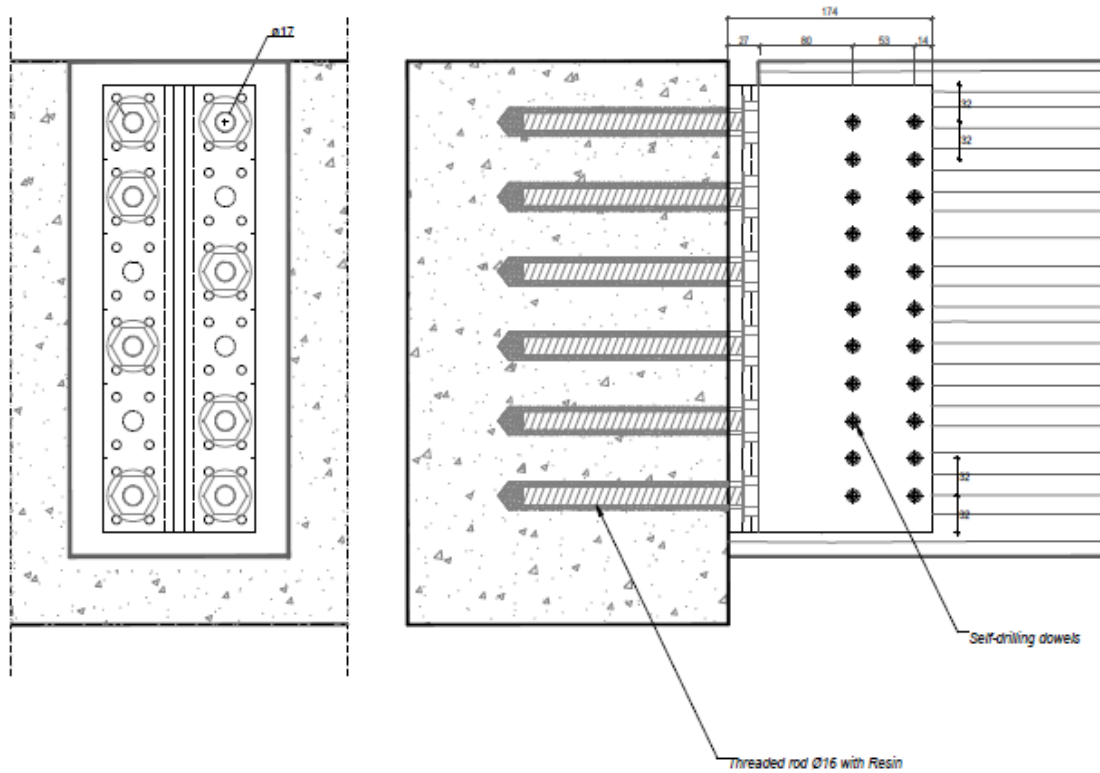

Austraße 34
 73235 Weilheim/Teck
 Tel 07023/743323-0
 Fax 07023/743323-90
 www.holzverblinder.de
 Info@holzverblinder.de

Use:

Alu Kombi Maxi without holes
 Timber–Concrete
 Threaded rod Ø16 mm with resin - Self drilling dowels Ø7 mm

Annex:

17a